

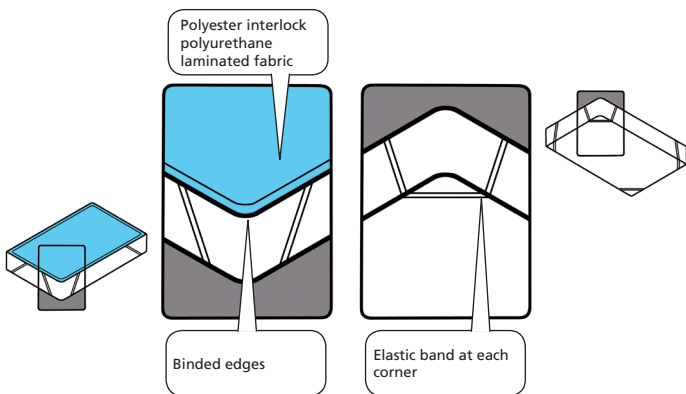

PLATEAU

Mattress protector plateau-style with polyester interlock polyurethane laminated fabric and four elastic bands at the corners (see drawing below for reference).



STANDARD

Mattress protector standard-style with polyester interlock polyurethane laminated fabric on surface and polyester interlock sides.

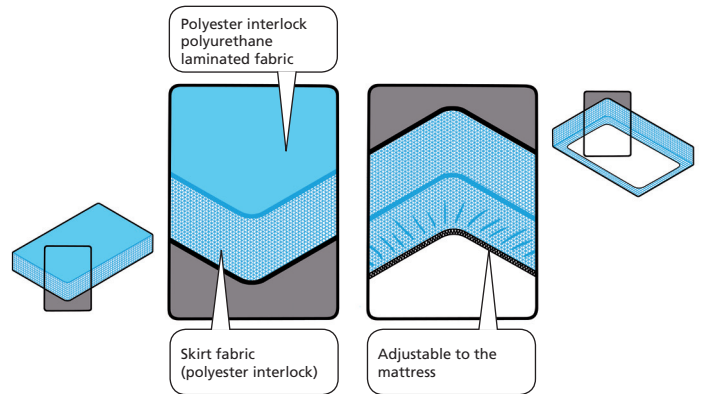

ENCASEMENT

Mattress encasement with polyester interlock polyurethane laminated fabric on surface, bottom and sides.

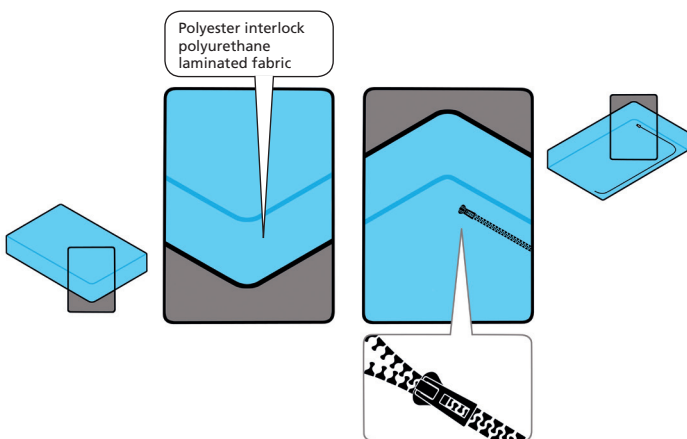

ENCASEMENT BUGSECURE

Bedbug-proof certified mattress encasement with polyester interlock polyurethane laminated fabric on surface, bottom and sides.

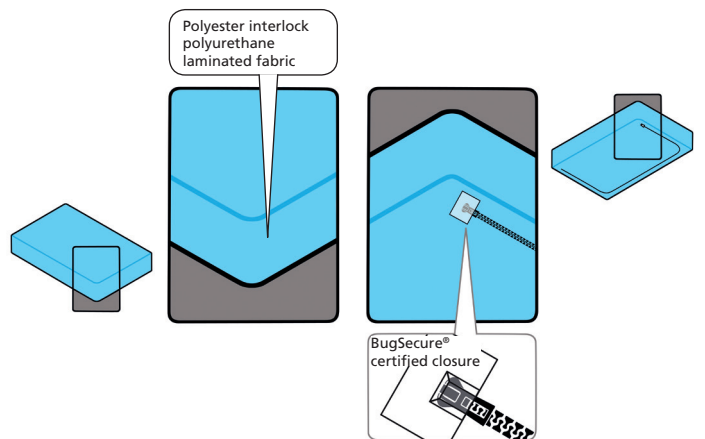

PRODUCT HANDLING



Machine washable up to 90°C (white)



Tumble dryable at low to medium temperature setting



Do not bleach or use solvents



Do not calender



Do not iron



Do not dry clean

FABRIC GENERAL DESCRIPTION

Polyester interlock fabric laminated with waterproof and breathable polyurethane film.

FABRIC TECHNICAL FEATURES

Properties	Values	Units
Textile weight	90 ± 5	grs/m ²
Total weight	125 ± 10	grs/m ²
Film composition	100% polyurethane	
Textile	100% polyester	
Water vapour transmission (breathability)	1000	grs/m ² · 24h
Hydrostatic head (waterproofness)	> 500	cm

PRODUCT INFORMATION

- **Waterproof, breathable** and **bi-elastic**.
- **Barrier against dust-mites, bacteria and fungi**.
- **Certified OEKO-TEX** Class 1 (test n° 991803 by AITEX).

SKIRT FABRIC

Interlock polyester fabric.

Properties	Values	Units
Interlock weight	90 ± 5	grs/m ²
Textile composition	100% polyester	